

BATTERY CHARGING

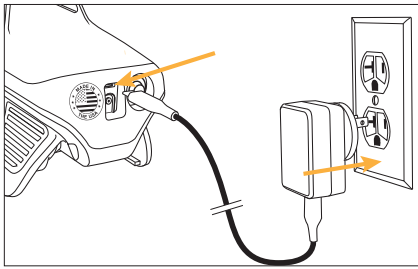

Use supplied 3-amp USB wall charger. Charge time: 7 to 8 hours approx.

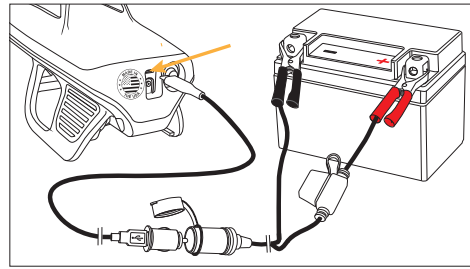

12V battery terminal charging with optional cables. Charge time: 10 hours approx.

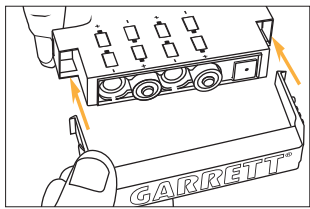

Axiom Booster pack uses eight (8) AA alkaline or NiMH batteries. Note proper polarity direction.

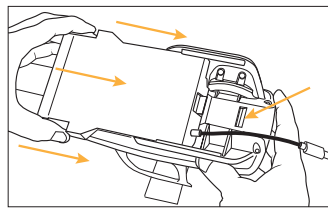

Clip Axiom Booster Pack into the stand below the detector cuff.

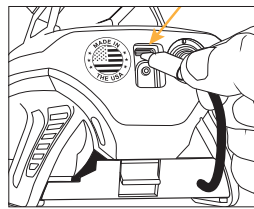

Plug cable into the USB connector on back of Axiom.

ADJUSTING ARM CUFF

Use hexnut wrench (stored below cuff) to remove four screws.

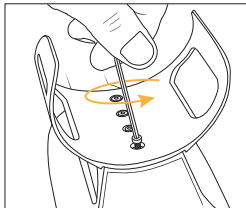

Move cuff up to two slots forward or backward (at least 2 bolts must be secured).

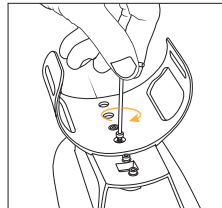

REGULATORY INFORMATION / INFORMACIÓN NORMATIVA / INFORMATIONS RÉGLEMENTAIRES

This device complies with part 15 of the FCC Rules. Operation is subject to the following two conditions: (1) This device may not cause harmful interference, and (2) this device must accept any interference received, including interference that may cause undesired operation.

Changes or modifications not expressly approved by the party responsible for compliance could void the user's authority to operate the equipment.

This device complies with Industry Canada license-exempt RSS standard(s). Operation is subject to the following two conditions: (1) this device may not cause interference, and (2) this device must accept any interference, including interference that may cause undesired operation of the device.

Ce produit est conforme aux normes RSS exemptes de licence d'Industry Canada. Son fonctionnement est soumis aux deux conditions suivantes : (1) ce dispositif ne peut pas provoquer d'interférences et (2) ce dispositif doit accepter toute interférence, y compris celles pouvant entraîner un dysfonctionnement.

Wireless Transmitter Specifications

Audio Delay:	17 milliseconds
Audio Bandwidth:	30-18,000 Hz
Operating Frequency:	2406-2474 MHz
Transmit Power:	8.6 dBm EIRP
Certifications:	FCC, CE, IC, AS/NZ

AXIOM™ Quick Start Guide

Click to access detailed Axiom guides in other languages.
 Cliquez pour accéder aux guides Axiom détaillés dans d'autres langues.
 اضغط للحصول على أدلة أكسيوم المفصلة باللغة الأخرى



ASSEMBLY

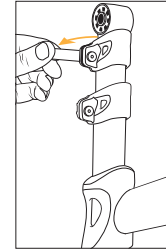

Release clamp, extend lower stem. Press the mounting washers into place.

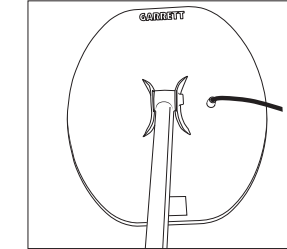
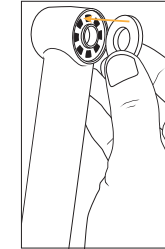
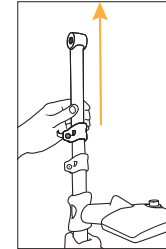

Insert lower stem into searchcoil bracket.

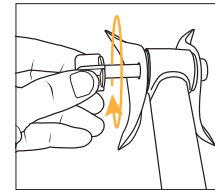

Insert bolt, and hand-tighten wing nut.

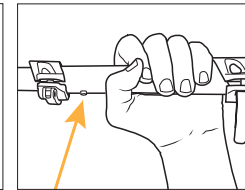

Lengthen lower stem until it snaps into place. Adjust upper stem.

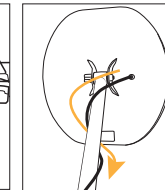

Wrap cable around stem, with the first turn of cable over the stem. Attach to back of control box, tighten collar.

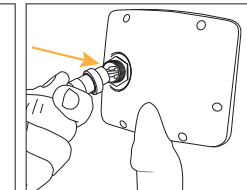

QUICK START

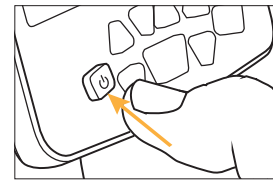

Power ON. Set Sensitivity, Threshold and Volume.

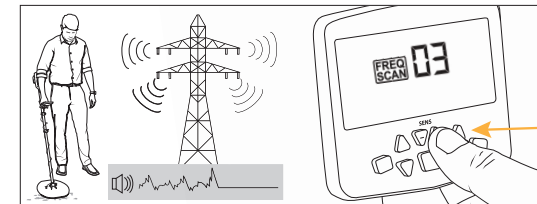

Perform Frequency Scan (if needed to eliminate EMI).

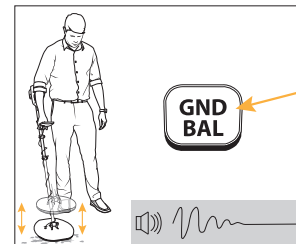

Ground Balance (if needed to eliminate ground response).

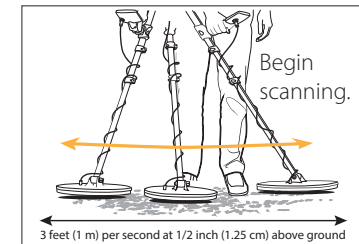

Begin scanning.

3 feet (1 m) per second at 1/2 inch (1.25 cm) above ground

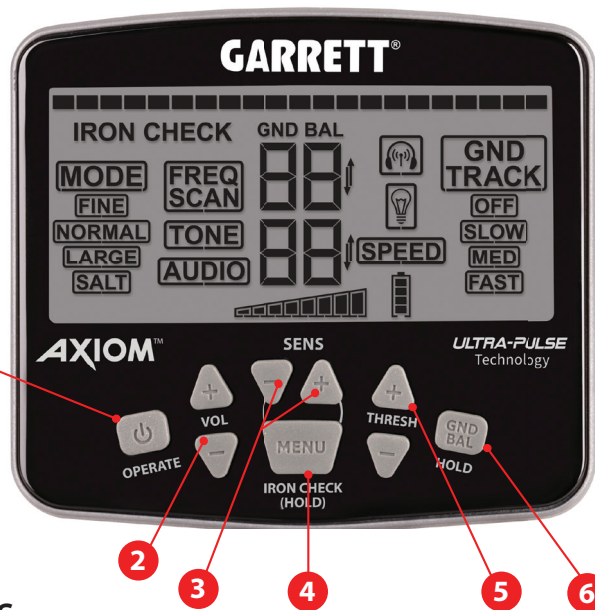

CONTROLS

- Power and Factory Reset**—Hold 1 second for power ON or OFF. Press and hold 5 seconds to restore Factory Settings. Tap to exit MENU settings.
- VOLUME Plus/Minus buttons**—Use to increase / decrease detector volume.
- SENSITIVITY Plus/Minus buttons**—Use to increase / decrease Sensitivity setting. These buttons are also used while adjusting MENU settings.
- MENU/Iron Check**—Repeatedly press to scroll through Menu items, then use the Plus (+) or Minus (-) buttons above MENU to change setting. Press and hold button to use Iron Check function.
- THRESHOLD Plus/Minus**—Use to adjust the background audio hum that is added to target response.
- Ground Balance**—Hold down while bouncing coil above ground until ground response disappears or becomes as small as possible.

FACTORY DEFAULT SETTINGS

Sensitivity:	4	Audio:	01 (VCO)
Volume:	25	Ground Balance:	49/49
Threshold:	15	Wireless:	Off
Mode:	Fine	Backlight:	Off
Frequency:	50	Speed:	Medium
Tone:	50	Ground Track:	Off

* Caution: Always power OFF your Axiom before changing searchcoils. Disconnecting and reconnecting coils while the detector is powered on could damage the searchcoil and/or the detector's electronics.

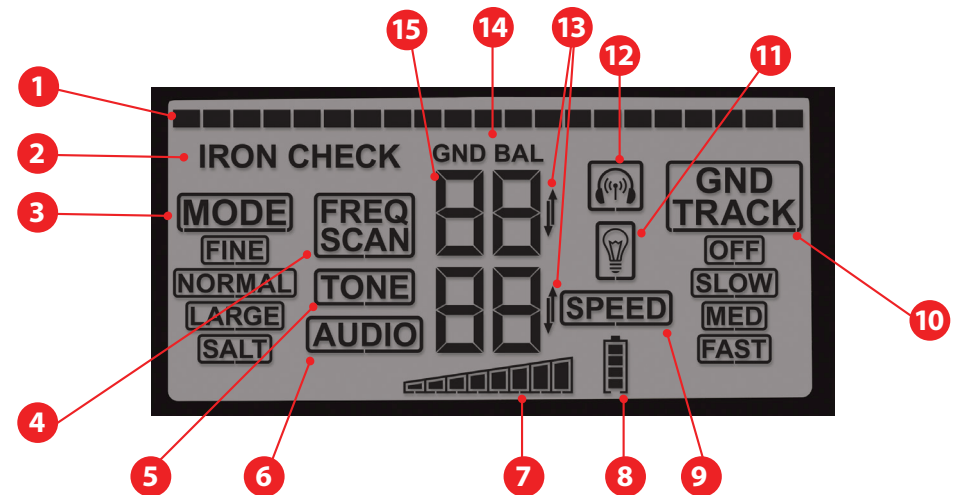

LCD/DISPLAY ELEMENTS

- Signal Strength Indicator**—indicates both signal strength and polarity.
- Iron Check**—Indicates that Axiom's Iron Check feature is in use.
- Mode**—Select from Fine, Normal, Large or Salt.
- Frequency Scan**—To overcome EMI, highlight FREQ SCAN on Menu, and press Plus (+) Menu button to begin the scan. Takes approximately 45 seconds.
- Tone**—Scroll through 00 to 99 to select your preferred audio tone.
- Audio Type**—Select 00 for PWM audio or 01 for VCO audio.
- Sensitivity**—Indicates current Sensitivity setting.
- Battery Level**—Shows status of battery life (25% per segment).
- Speed**—Select Slow, Medium or Fast detection speed.
- Ground Track**—Select Off, Slow, Medium or Fast continuous ground tracking speeds.
- Backlight**—Indicates LCD Backlight is on.
- Wireless headphones**—Press Plus (+) Menu button to pair to headphones or Minus (-) to unpair. Icon flashes while attempting to pair; is solid when unit is paired with headphones.
- Gnd Balance Arrows**—Indicates trending direction of ground balance when Gnd Track is on.
- Gnd Balance Indicator**—Displays while performing ground balance.
- Ground Balance Values**—are shown by the upper and lower 2-digit numbers.